

- ◆ MATERIAL: RUBBER
- ◆ COLOR: BLACK/GRAY/ COMPUTER
- ◆ UNIT: mm
- ◆ OTHER MATERIALS AVAILABLE: EPDM, SILICON, ...
- ◆ PRL9-4 MATERIAL: PORN
- ◆ OPTIONAL THICKNESS: 0.5~3.2mm

PART NO
RF18-5A

PART NO	A	B	C
RF6-5	6.0	5.0	5.0
RF-003	10.0	9.5	4.2
RF-030			8.0
RF-009	10.8	10.2	3.0
RF11-5	11.0	9.6	5.0
RF-011		10.5	
RF11-3.2A	11.3	10.7	3.2
RF12-27A	11.7	10.6	2.85
RF-039	11.9	11.2	6.4
RF-015	12.0	11.2	5.1
RF-019		9.5	4.0
RF-019A	12.7	10.0	3.8
RF-032		11.5	4.0
RF-005	13.0	11.4	5.0
RF-012		12.2	4.5
RF-007	19.0	17.0	7.2
RF-020		15.8	4.2
RF20-5	19.8	18.0	5.0
RF-008	20.0	19.0	6.0
RF24-8	24.0	20.0	8.5

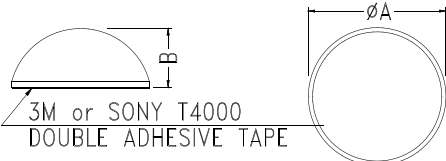
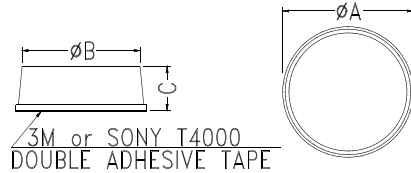

PART NO	A	B
RF-021	6.7	4.2
RF-1106	11.0	6.0
RF-022	11.3	5.6
RF14-8A	14.0	8.0
RF-006	15.9	
RF21-8.5	21.6	8.52
RF21-10		10.0

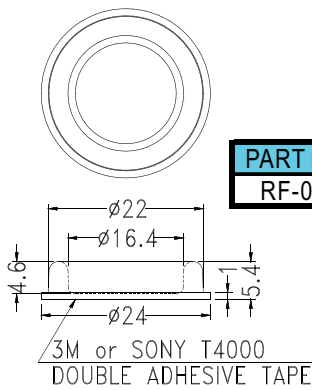

PART NO
RF-031

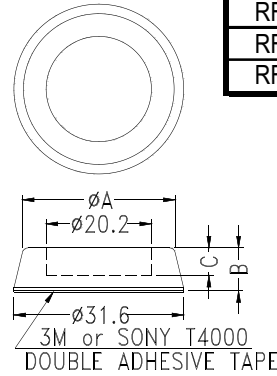

PART NO	A	B	C
RF-016	29.6	6.6	4.1
RF-017	29.0	8.8	4.9

PART NO	A	B	C	D	E
RF-018	22.3	19.6	4.9	9.0	9.8
RF20-10	21.0	18.1	10.6	6.9	10.6
RF-029	22.3	19.0	6.5	7.2	10.2

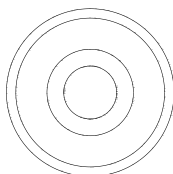
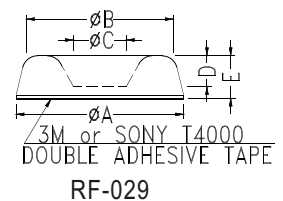
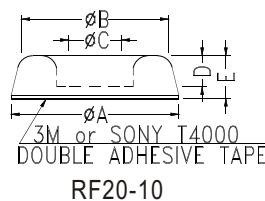
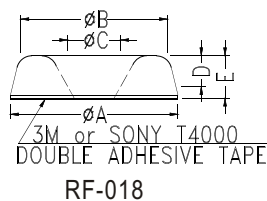

PLASTIC & RUBBER FOOT

Hankook Fastener

- ◆ MATERIAL: RUBBER/PU
- ◆ COLOR: BLACK/GRAY/COMPUTER
- ◆ UNIT: mm

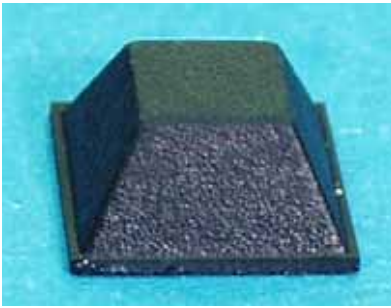

PART NO	A	B	C
SF-004	12.7	9.0	3.5
SF-005	12.7	7.0	6.0
★ SF-005I	12.7	7.0	5.5
SF-006	20.5	14.0	7.6
SF-007	10.5	8.6	2.5
SF-009	12.5	9.5	4.0
SF-016	12.7	9.8	3.0
SF-017	12.5	9.7	3.5

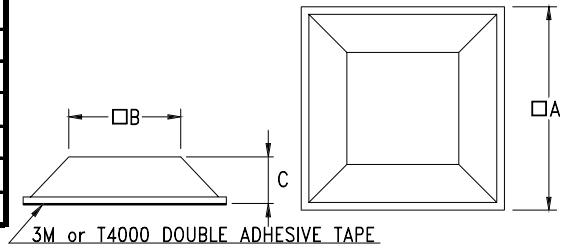

- ◆ MATERIAL: RUBBER
- ◆ COLOR: BLACK/GRAY/COMPUTER
- ◆ UNIT: mm
- ◆ OTHER MATERIALS AVAILABLE: EPDM, SILICON, ...
- OPTIONAL THICKNESS BETWEEN 0.7~5.0mm

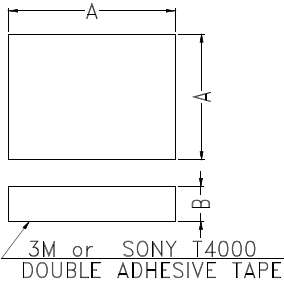

PART NO	A	B
SF-050510	5.0	1.0
SF050512		1.2
SF-6610	6.0	1.0
SF-6615		1.5
SF060625		2.5
SF-664		4.0
SF-665		5.0
SF060660		6.0
SF-001		6.4
SF070715	7.0	1.5
SF070720		2.0
SF070740		4.0
SF070755		5.5
SF070780	8.0	8.0
SF-080801	8.0	1.0
SF-080802		2.0
SF080823		2.3
SF-0808025	2.5	2.5
SF090945	9.0	4.5
SF-002	9.7	2.0

PART NO	A	B
SF-979735	9.7	3.5
SF101007	10.0	0.7
SF101009		0.9
SF101010		1.0
SF101016		1.6
SF101020		2.0
SF101023		2.3
SF101025		2.5
SF101030		3.0
SF101035		3.5
SF101040		4.0
SF101050	5.0	
SF101060	6.0	
SF111160	11.0	11.0
SF11511550	11.5	5.0
SF11511565		6.5
SF-121212	12.0	1.2
SF121225		2.5
SF-003		5.0
SF121255	5.5	5.5

PART NO	A	B
SF121270	12.0	7.0
SF-1272	12.7	2.3
SF-131320	13.0	2.0
SF14142	14.0	
SF141480		15.0
SF151512	15.0	1.5
SF-151515		3.5
SF151535		5.0
SF151550	16.0	1.0
SF161610	17.0	2.5
SF171725	18.0	1.0
SF181810		2.0
SF181820		4.0
SF181840	5.0	5.0
SF181850	20.0	3.0
SF202030	25.4	5.0
SF25425450	40.0	1.0
SF404010	50.0	5.0
SF404050		1.0
SF505050	5.0	5.0

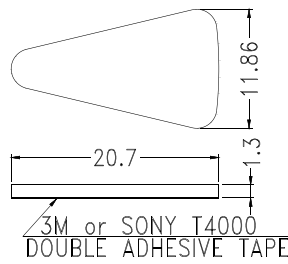

PART NO	PACKAGE
TF201113	1000

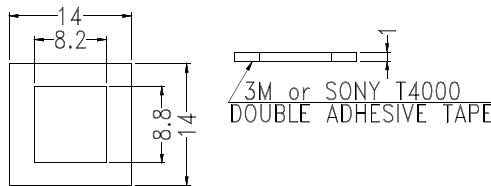

PART NO
SF141410

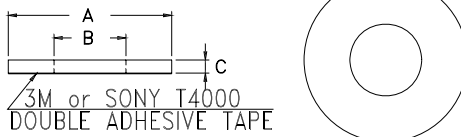

PART NO	A	B	C
RWF3.5-0.5	8.0	3.5	0.5
RWF3.5-1			1.0
RWF3.5-1.5	11.0	8.5	1.5
RWF18-8.5-15	18.0		
RWF20-1.5	20.0		
RWF25-2	25.0	11.0	2.0
RWF40-2	40.0	12.0	
RWF43-2	43.0	30.1	

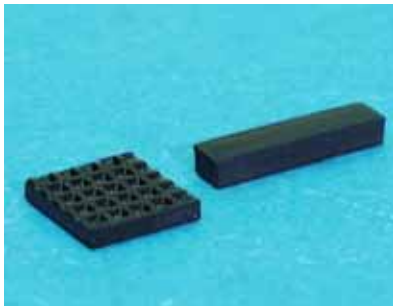

- ◆ MATERIAL: RUBBER
- ◆ COLOR: BLACK/GRAY/ COMPUTER
- ◆ UNIT: mm
- ◆ OTHER MATERIALS AVAILABLE: EPDM, SILICON,
- ◆ OPTIONAL THICKNESS IS BETWEEN 0.5~10mm

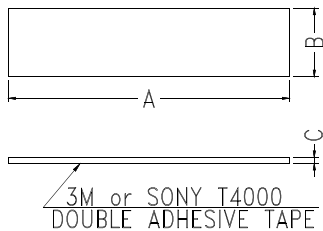

PART NO	A	B	C	
SF340220	34.0	2.0	2.0	
SF340904	34.6	9.5	0.4	
SF-340901	34.7	9.7	1.0	
SF351001	35.0	10.0	1.0	
SF351580		15.0	8.0	
SF352508		25.0	0.8	
SF361810	36.0	18.0	1.0	
SF361820			2.0	
SF400509	39.5	5.0	0.9	
SF-4009	40.0	9.0	1.5	
SF400924			2.4	
SF400930		3.0		
SF401040		10.5	4.0	
SF401235		12.0	3.5	
SF401240			4.0	
SF401250			5.0	
SF401715		17.5	1.5	
SF442010	44.5	20.0	10.0	
SF451020	45.0	10.0	2.0	
SF473530	47.5	3.5	3.0	
SF481040	48.0	10.0	4.0	
SF484410		44.0	1.0	
SF491210	49.0	12.0	2.0	
SF500620	50.0	6.0	2.0	
SF501038	50.0	10.0	3.8	
SF541010	54.0		1.0	
SF550515	55.0	5.0	1.5	
SF582508	58.0	25.0	0.8	
SF582514			1.4	
SF582516			1.6	
SF600610			1.0	
SF600613	6.0	1.3		
SF600625		2.5		
SF-6064		4.0		
SF600907	60.0	9.0	0.7	
SF601010		10.0	1.0	
SF601025			2.5	
SF6017530		17.5	3.0	
SF602010		20.0	10.0	
SF652020		65.0	20.0	2.0
SF654030			40.0	3.0

PART NO	A	B	C
SF700525	70.0	5.0	2.5
SF70182		18.0	2.0
SF702010		20.0	1.0
SF764005	76.0	40.0	0.5
SF-801004	80.0	10.0	
SF845208	84.6	52.6	0.8
SF880810	88.0	8.0	1.0
SF951232	95.0	12.0	3.2
SF980830	98.0	8.0	3.0
SF993555	99.0	3.5	5.5
SF990915		9.9	1.5
LSF-002	100.0	12.0	3.5
SF107581	107.0	58.0	1.5
SF1100540	110.0	5.6	4.0
SF1101010		10.0	1.0
SF1111009			0.9
SF1200310	120.0	3.0	1.0
SF1254620	125.0	46.0	2.0
SF1302030	130.0	20.0	3.0
SF1302020			2.0
SF1340220	134.0	2.0	1.0
SF1400520	140.0	5.0	
SF140101		10.0	
SF140251		25.0	
SF14510520	145.0	105.0	2.0
SF1461010	146.0	10.0	1.0
SF1500712	150.0	7.0	1.2
SF-1501004		10.0	0.5
SF1501515		15.0	1.5
SF1600610	160.0	6.0	1.0
SF1664930	166.5	49.0	3.0
SF2500515	250.0	5.0	1.5
SF2506520		65.0	2.0
SF2701655	270.0	165.0	0.5
SF2581420	258.0	14.5	2.0
SF3101150	310.0	11.6	5.0
SF3101250		12.0	
SF5400208	540.0	2.9	0.8

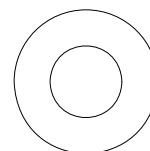
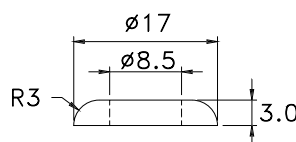

- ◆ MATERIAL: RUBBER
- ◆ COLOR: BLACK
- ◆ UNIT: mm

PART NO
RWF8.5-3N

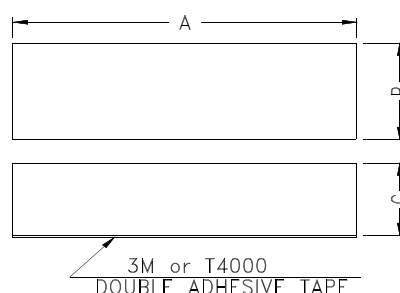

- ◆ MATERIAL: EVA
- ◆ COLOR: BLACK
- ◆ UNIT: mm
- ◆ PROVIDING SERVICE FOR ANY DIMENSIONS REQUIRED

PART NO	A	B	C
EVA120430	12	4.0	3.0

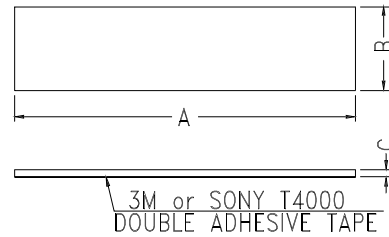
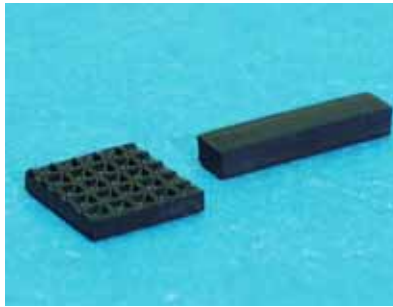

- ◆ MATERIAL: RUBBER
- ◆ COLOR: BLACK/GRAY/ COMPUTER
- ◆ UNIT: mm
- ◆ OTHER MATERIALS AVAILABLE: EPDM, SILICON,
- ◆ OPTIONAL THICKNESS IS BETWEEN 0.5~10mm

PART NO	A	B	C
SF050435	5.0	4.5	3.5
SF062313	6.0	2.3	1.3
SF060425		4.0	2.5
SF652840	6.5	2.8	4.0
SF652850			5.0
SF070215	7.0	2.0	1.5
SF070216			1.6
SF070304		3.0	0.4
SF073512		3.5	1.2
SF070420		4.0	2.0
SF070620		6.0	
SF080625	8.0	6.0	2.5
SF852530	8.5	2.5	3.0
SF853520		3.5	2.0
SF853525			2.5
SF80452	8.0	4.5	2.0
SF090855	9.6	8.0	5.5
SF100616	9.9	6.0	1.6
SF100119	10.0	1.9	1.9
SF103512		3.5	1.2
SF100409		4.0	0.9
SF100510		5.0	1.0
SF100520			2.0
SF100712		7.0	1.2
SF100825		8.0	2.5
SF100850			5.0
SF100730			10.5
SF110830		11.5	8.0
SF118781	11.8	7.8	1.0
SF120565	12.0	5.0	6.5
SF120810		8.5	1.0
SF129515		9.5	1.5
SF121530		15.0	3.0
SF1256535	12.5	6.5	3.5
SF1251008		10.0	0.8
SF-1251015			1.5
SF130620	13.0	6.0	2.0
SF130630			3.0
SF130735		7.0	3.5
SF130740			4.0
SF130855			13.5
SF132525	13.0	2.5	2.5

PART NO	A	B	C	
SF140430	14.0	4.0	3.0	
SF140440			4.0	
SF150320	15.0	3.2	2.0	
SF150610		6.0	1.0	
SF151016		10.0	1.6	
SF151930		1.9	3.0	
SF152530		25.0		
SF155030		50.0		
SF1585601	15.8	5.6	1.0	
SF151025		10.0	2.5	
SF-163530	16.0	3.5	3.0	
SF160536		5.0	3.6	
SF170525	17.0	5.0	2.5	
SF1724330	17.2	4.3	3.0	
SF180930	18.0	9.0		
SF181010		10.0	1.0	
SF181020			2.0	
SF195640	19.0	5.6	4.0	
SF195720		5.7	2.0	
SF-197774	19.7	7.7	4.0	
SF197760			6.0	
SF190814		8.0	1.4	
SF190815			1.5	
SF-1979723		9.7	2.3	
SF1979725			2.5	
SF1979730			3.0	
SF-1972015		20.0	1.5	
SF202515		20.0	2.5	1.5
SF200410			4.0	1.0
SF200420	2.0			
SF200510	5.0		1.0	
SF200515			1.5	
SF200563			6.3	
SF200568			6.8	
SF200725	7.0		2.5	
SF201010	10.0		1.0	
SF201015			1.5	
SF201020		2.0		
SF201035		3.5		
SF201056		5.6		
SF201465		14.0	6.5	
SF201515	15.0	1.5		

PART NO	A	B	C
SF200612	20.5	6.0	1.2
SF210804	21.5	8.6	0.4
SF-221615	22.0	16.0	1.5
SF227640	22.6	7.6	4.0
SF237640	23.0		
SF230610	23.7	6.5	1.0
SF246011	24.8	6.0	1.1
SF250535	25.0	5.0	3.5
SF250550			5.0
SF250760		7.0	6.0
SF250810		8.0	1.0
SF250815			1.5
SF250820			2.0
SF251235	12.0	3.5	
SF251224	25.4	12.7	2.4
SF251232			3.2
SF260510	26.8	5.5	1.0
SF270830	27.0	8.0	3.0
SF271810		18.0	1.0
SF271820			2.0
SF279032	27.5	9.0	3.2
SF-3064	30.0	6.0	4.0
SF303555		3.5	5.5
SF30709		7.0	0.9
SF3038		8.0	3.8
SF-301120		11.0	2.0
SF-301140			4.0
SF301230		12.0	3.0
SF301250			5.0
SF301525			15.0
SF302055		20.0	5.5
SF302501	25.0	1.0	
SF30511	30.5	11.0	7.0
SF311510	31.5	15.5	1.0
SF311515			1.5
SF3267225	32.0	6.7	2.25
SF321720		17.0	2.0
SF321725			2.5
SF332055	33.0	20.0	5.5
SF332385	33.3	23.3	8.5
SF331125	33.5	11.5	2.5